



ZKT_{eco}

利剑出鞘 //
// 谁与争锋

01

Pictures



UA760



UA860



Standard WIFI, support push function



BioID Pass CE/FCC certification



Function module Design:
TCP/IP、Simple A/C、RS232 print



12V 1.5A power design more stable

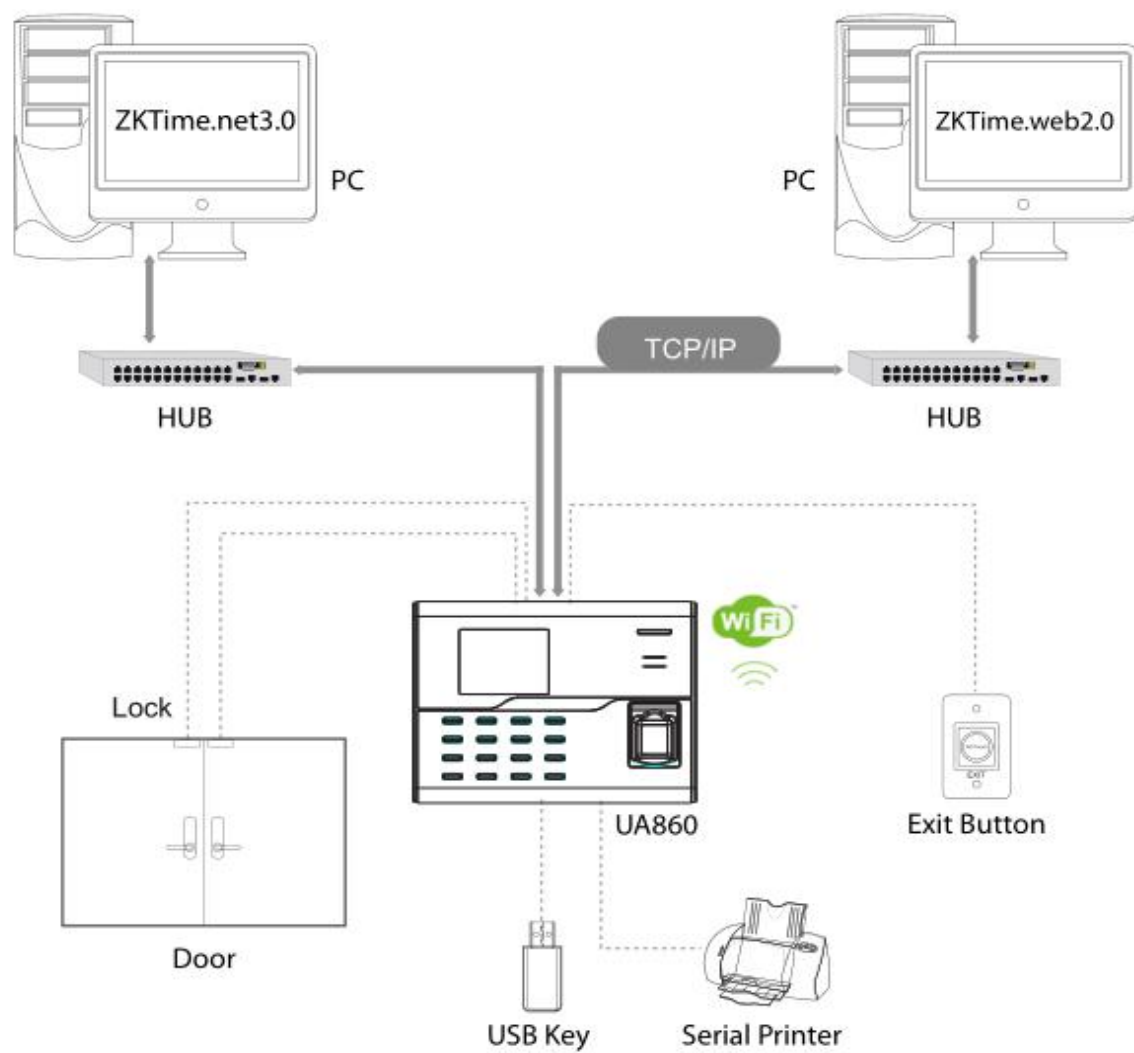

Terminal diagram

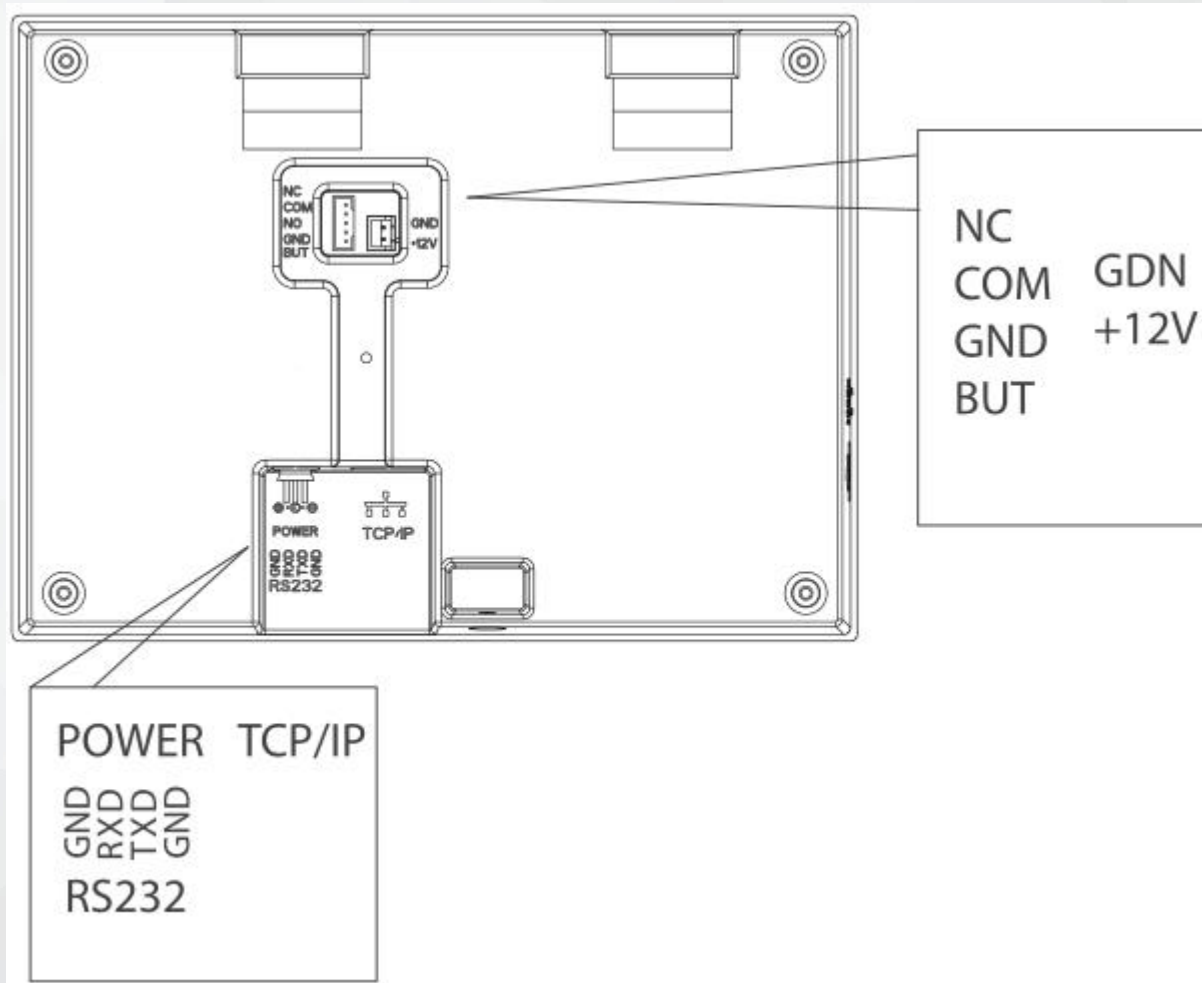

User Capacity	3000
Fingerprint Capacity	3000
ID Card Capacity	3000 optional
Record Capacity	50,000
Display	2.8" color screen
Communication	TCP/IP, WiFi, USB-host
Standard Functions	9 Digit User ID, T9 Input, SMS, DST, Self-Service Query, Automatic Status Switch, Ring bell
Optional Functions	ID/Mifare, WDMS, RS232 External Printer
Access Control Interface	3rd Party Electirc Lock, Exit Button
Software	ZKTime.Net 3.0
Power Supply	DC 12V/1.5A
Dimension	186*138*43.6mm (LxWxT)
Operating Temp.	0 °C - 45 °C
Operating Humidity	20% - 80%

New generation, 2.8 inch color screen T&A

Standard WIFI、12V Power、BioID、Back battery、push、simple A/C

Module design

Product comparison

	K series	WL series	UA series	3 inch color screen
Type	K30	WL10/WL20/WL30	UA760/UA860	IN01
picture				
screen	2.8' TFT	2.8' TFT	2.8' TFT	3.0' TFT
mainboard	FINGER LITE	WU28	ZLM60 (new framework)	U990
commincation	TCP/USB host	WIFI/USB host/USB Client	WIFI/TCP/USB host	TCP/USB host/USB Client
Finger Reader	ZK2650	BioID	BioID	ZK2000
A/C	Simple A/C	NO	Simple A/C	NO
Push	NO	NO	Yes	optional
Back battery	Yes	NO	Optional	Yes
optional	ID/MF	TimeCube	ID/MF, RS232 Print	ID/MF/HID, WIFI, ADMS, GPRS

07

project progress



Handover to production
Done

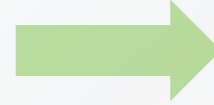

HD Picture Done

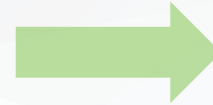

Color page design Done

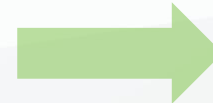

Listed Guide Done

BioID certification testing ,



A black and white photograph of a fencer in a white uniform, holding a foil. The fencer's right hand is in a ready position, gripping the hilt. A rectangular box highlights the hand and hilt area. The background is a light gray with a diagonal split.

ZKT_{eco}

利剑出鞘 //
// 谁与争锋